

Installation of Fiberglass Window through installation bracket with Jamb extension

The window is shipped from the factory with all four pieces of jamb extension attached to the window. The two vertical side pieces must be removed in order to secure the window to the framing.

Removing the two vertical side pieces of jamb extension:

- Remove the screws on the top and bottom corners of the jamb extension. Be sure not to remove any in screws from the corners of the fiberglass frame.
- Remove the side jamb extensions.

Installing the window:

- Install the window into the opening as per Norwood's installation instructions. See figure 1.

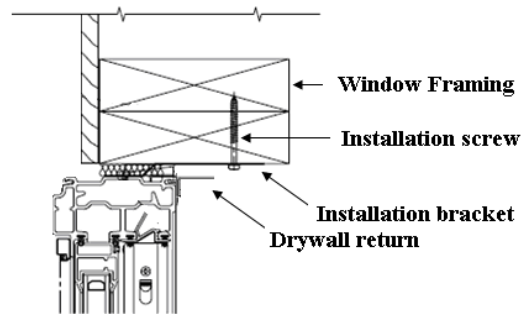

Figure 1

Reinstalling Jamb extension:

- Set the jamb extensions in place.
- Shim the back of the jamb extension until it is in the proper location.
- Drive a finishing nail through the jamb extension and the shims. See figure 2.

Note: the jamb extensions should be shimmed where the nails are driven to stabilize the jamb extension.

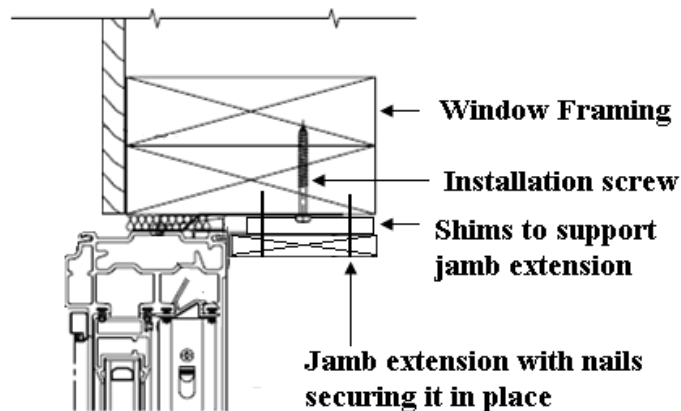

Figure 2